

## VARIO 2.0

Adaptable lower section – Configure the lower section of your hydrant according to your requirements

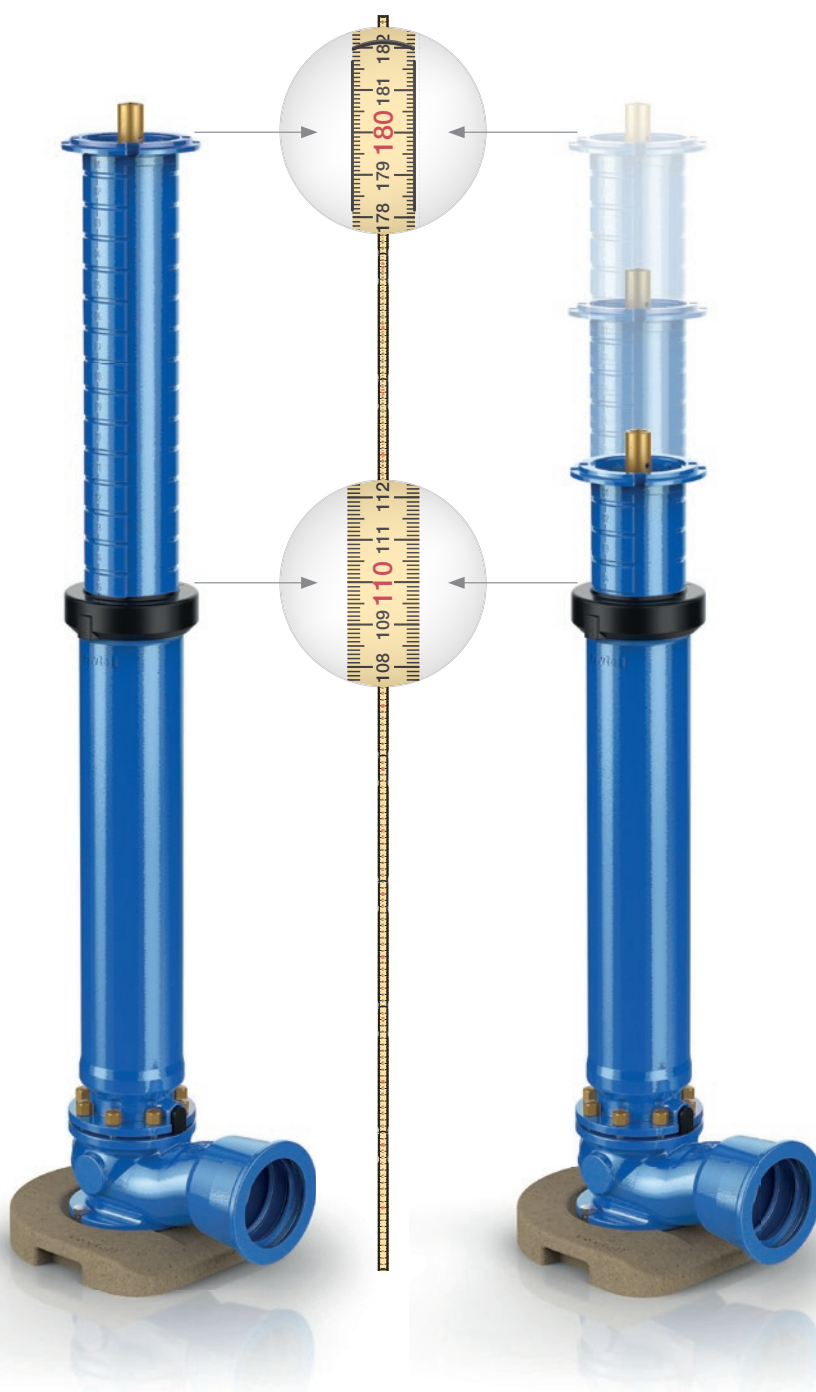

## The new standard

The lower section of the VARIO 2.0 hydrant contains the main valve and a riser for bridging the vertical distance between the water pipe connection and the upper part of the hydrant. The lower sections of the VARIO 2.0 range can be assembled together with all commonly used upper sections, whether they are vonRoll products or not, to form complete hydrants. In making this possible, the VARIO 2.0 sets a new standard in simplicity and flexibility.

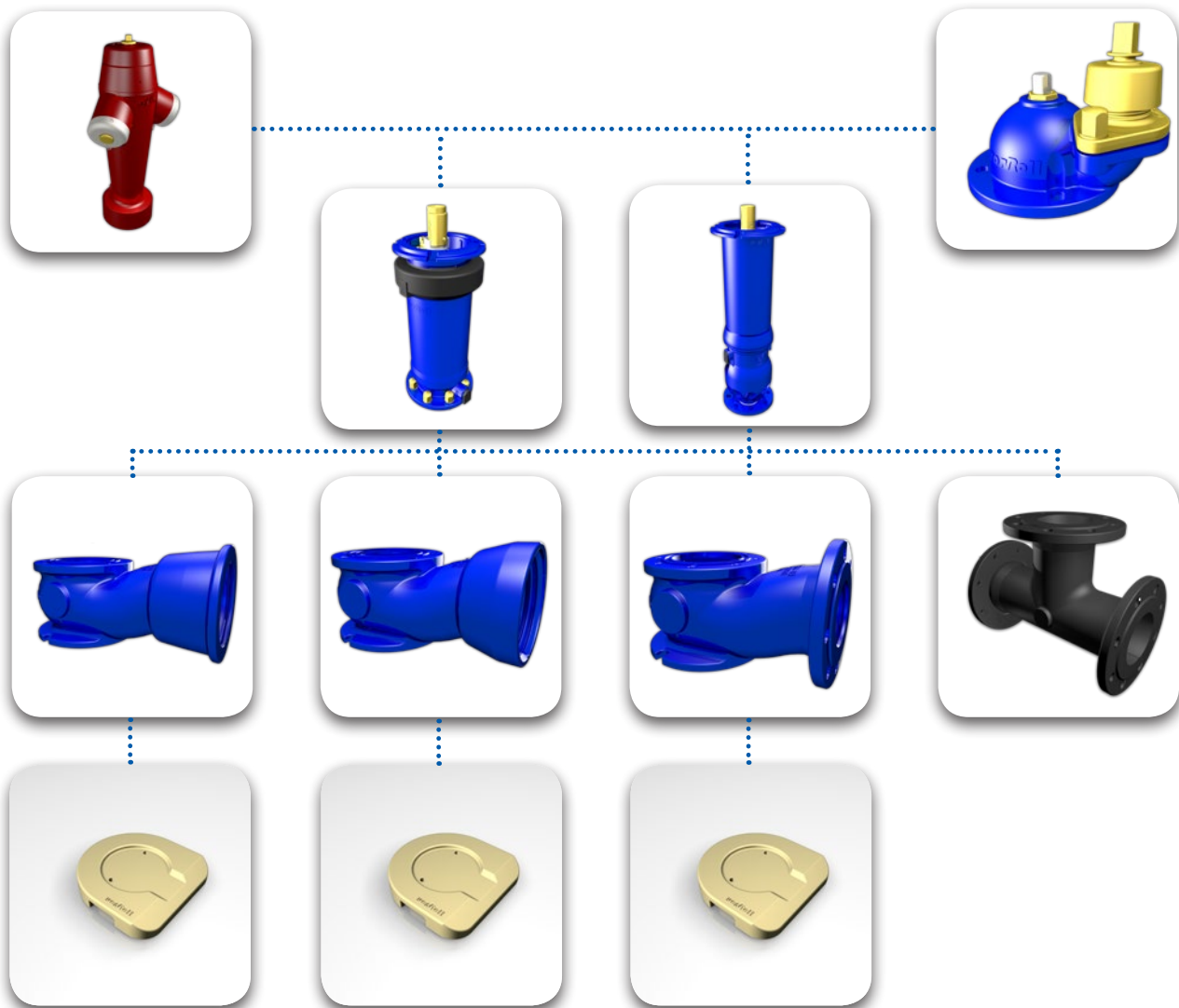

### Quick configuration however you want it

At vonRoll hydro, we always look to use standard interfaces – and with good reason.

Give us your hydrant specifications and, with the VARIO 2.0, we can assemble and deliver countless variant types, exactly according to customer requirements. Almost unlimited flexibility is also a great benefit for partners who hold stocks of our products. Any variety of combinations can be quickly assembled on the spot.

## From 110 to 180 cm in 30 seconds

### Easy height adjustment in seconds

Never before was it possible for the height of a hydrant's lower section to be adjusted so easily and quickly – by just one person. It's really simple: You loosen two screws, turn the telescopic pipe 180° and adjust the VARIO 2.0 to the desired height. Next, turn the telescopic pipe back to the original position and the setting is locked in place. Then screw the moveable strap tight again.

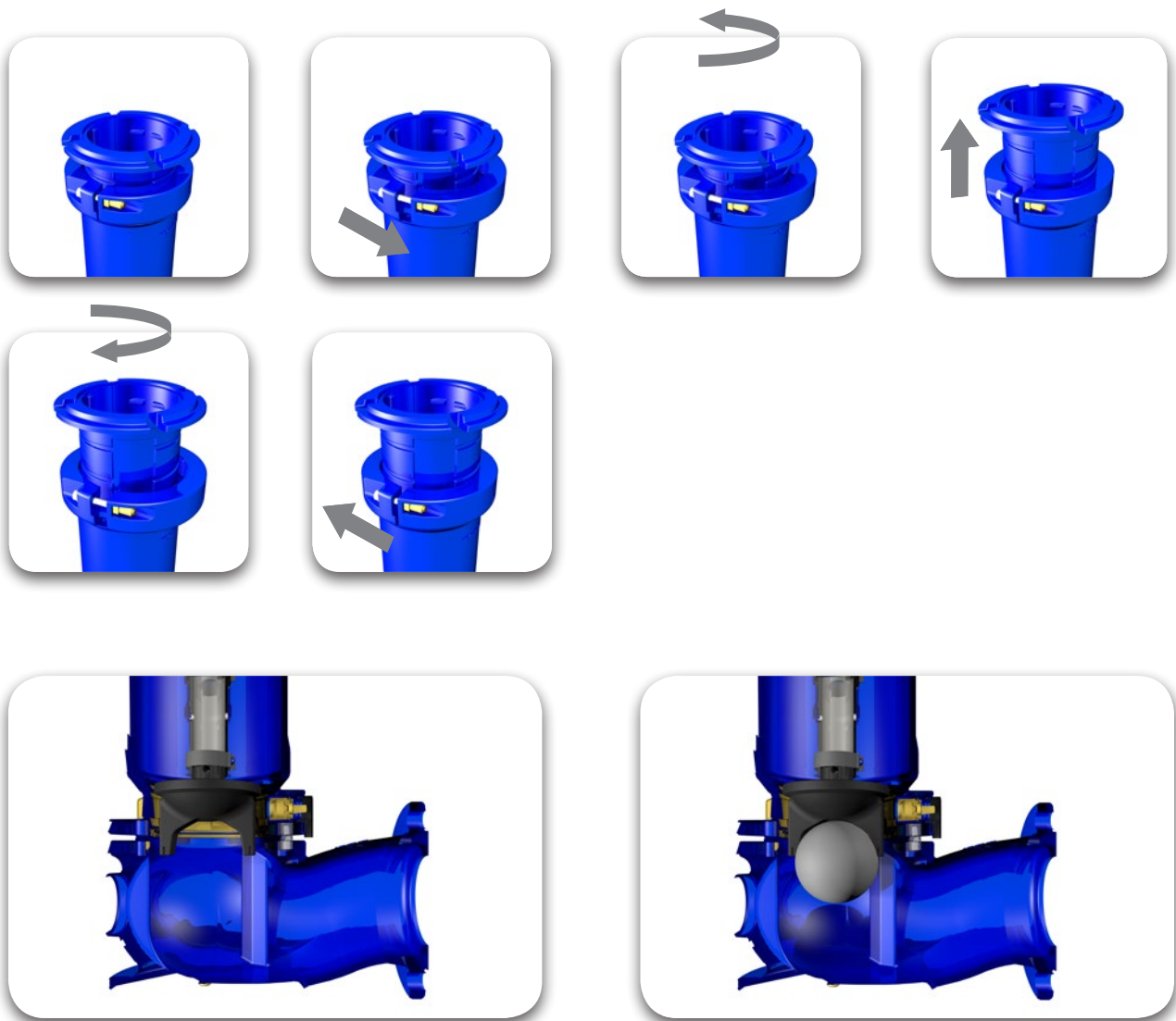

### Universal main valve seat

Both conical and radial valves can be used in the main valve seat of the VARIO 2.0. The valve seat is replaceable, which allows the dual shut-off ball to be retrofitted or serviced.

### An overview of the benefits of the VARIO 2.0

- Extremely easy height adjustment
- Modular system allowing modular organisation for countless combination options
- Approx. 30 per cent lighter than comparable products
- Lower sections from well bottom = 0.4 m (incl. dual shut-off and height adjustment)
- Universal main valve seat for both conical and radial valves
- Valve can be changed from conical to radial (without groundwork)
- Main valve seat replaceable, dual shut-off can be retrofitted
- Optimised flow rate.

### Options

- Polymer concrete base for optimum positioning of the VARIO 2.0 when fitting in the well
- Dual shut-off (DSO)
- G2" internal thread for domestic connection on the right, on the left or at the rear



Would you like a demonstration of the VARIO 2.0 without obligation?

Contact us: